

MOTOMAN MS165

Spot Welding with the MS-series

The 6-axis MOTOMAN MS165 is a versatile, high speed robot offering superior performance in spot welding applications. The MOTOMAN MS165 offers a large motion range and is equipped with external cables for flexible mounting of large spot welding

guns, which contributes to increase the number of welding points per manipulator. The width of the MOTOMAN MS165 has been decreased by 625 mm and the installation area has also been reduced. In addition the payload has been increased to 165 kg. The number of power cables has been reduced from two to one resulting in reduced maintenance. A new vibration control system has been developed thanks to higher rotational axis speeds and rigidity of speed reducers. By reducing the cycle times, this system realises high increases in productivity.



KEY BENEFITS

- Fast, flexible and powerful
- High payload: 165 kg
- Wide motion range: 2702 mm
- Maximum performance using minimal floor space
- Equipped with media hose package for mounting spot welding guns
- Reduced maintenance (cable reduction from 2 to 1)

MOTOMAN MS165



Allowable wrist load

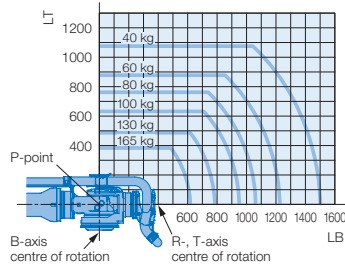
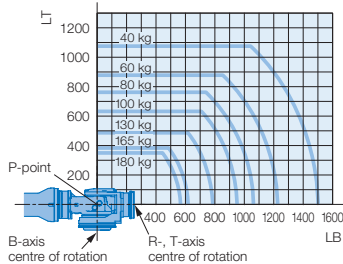

View A

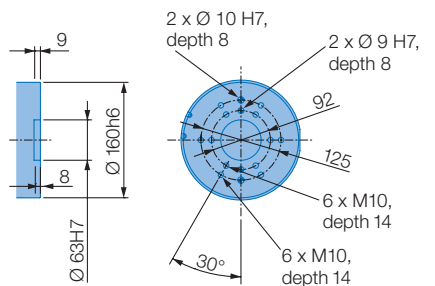

View B

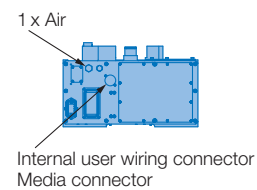

View C

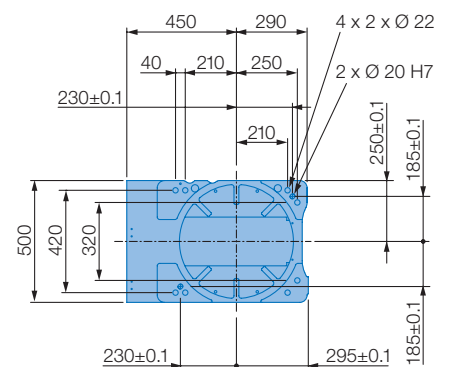

Mounting option: Floor

Protection class: IP54/67

All dimensions in mm | Technical data may be subject
to change without previous notice | Please request detailed
drawings at robotics@yaskawa.eu.com –
YR-MS00165-A00, E-04-2016, A-No.166336

Specifications MS165

* Recommended values

Axes	Specifications MS165								* Recommended values		
	Maximum motion range [°]		Maximum speed [°/sec.]		Allowable moment [Nm]		Allowable moment of inertia [kg · m²]		Flange		
									without	with	
Flange	without	with*	without	with	without	with	without	with	Controlled axes	6	
S	±180		125		–		–		Max. payload [kg]	180	165
L	+76/–60		115		–		–		Repeat. pos. accuracy [mm]	±0.2	
U	+90/–147		125		–		–		Max. working range R [mm]	2702	
R	±360	±210	182		1000	951	90	88	Temperature [°C]	0 to +45	
B	±130		175		1000	951	90	88	Humidity [%]	20 – 80	
T	±360	±210	265		618		46.3		Weight [kg]	970	
									Power supply, average [KVA]	5.0	

YASKAWA

robotics@yaskawa.eu.com
www.yaskawa.eu.com

YASKAWA Headquarters

YASKAWA Europe GmbH · Robotics Division
Yaskawastraße 1 · D-85391 Allershausen
Tel. +49 (0) 8166/90-0 · Fax +49 (0) 8166/90-103

YASKAWA ACADEMY and sales office Frankfurt

YASKAWA Europe GmbH · Robotics Division
Hauptstraße 185 · D-65760 Eschborn
Tel. +49 (0) 6196/77725-0 · Fax +49 (0) 6196/77725-39